

PADDY DRYER

NSDR Series



NSDR30C-C

SATAKE CORPORATION

PADDY DRYER

Specifications

Model			NSDR	
Type			15B-C	30B-C/30C-C
Primary Material			Paddy, Wheat	
Holding Capacity / Batch		Paddy (ton) *1	6.3~15	7.2~30
		Wheat (ton) *2	7.6~18	8.5~30
		Size (m³)	26.8	53.6
Performance	Loading	Paddy (ton/Hr) *3	20	30
		Wheat (ton/Hr) *3	23	30
		Paddy (ton/Hr) *3	20	30
	Unloading	Wheat (ton/Hr) *3	23	30
		Paddy (%/Hr) *4	0.3~0.8	
		Wheat (%/Hr) *4	0.3~0.9	
Heated Air Source	Equipment		Biomass Air-heating Furnace/ Steam Heat Exchanger	
	Fuel		Rice Husk (Coal)	
	Temperature Control		Automatic	
Ventilation Fan	Model		FR60	
	Type		Centrifugal Type	
Power Consumption	Voltage (V)		3 Phase 380V/400V/415V/440V	
	Rated Output	Ventilation Fan (kW)	7.4 (3.7 x 2)	16.5 (5.5 x 3)
		Lower Screw (kW)	-	1.5
		Bucket Elevator (kW)	2.2	3.7
		Rotary Valve (kW)	0.2	0.2
		Disperser (kW)	-	0.75
Equipment	Maximum Concurrent Usage of Power (kW)		22.8	
	Safety Devices		(1) Grain Temperature Sensor, (2) Overload Thermal Relay, (3) Seismic Equipment	
	Operating Control Method		Microcomputer Control (Control of Drying Speed)	
	Standard Equipment		(1) Automatic Moisture Meter, (2) Full Quantity Sensor, (3) Cleaner (4) Automatic Switch Valve for Unloading, (5) Touch-screen Control Panel	
Optional Equipment			(1) Hoppers (Lower Hopper, Upper Slot), (2) Handrail, (3) Ladder (4) Emergency Stop Switch, (5) Touch-screen Remote Control Panel	

*1 In volume weight of material is 560 kg/m³
*2 In volume weight of material is 680 kg/m³
*3 Performance will change depending on system design.
*4 Drying rate will change depending on material condition (moisture, foreign material contamination, variety), outside circumstance (outside temperature, outside humidity) and operating conditions (operation mode, installation site).

Dimensions (mm)

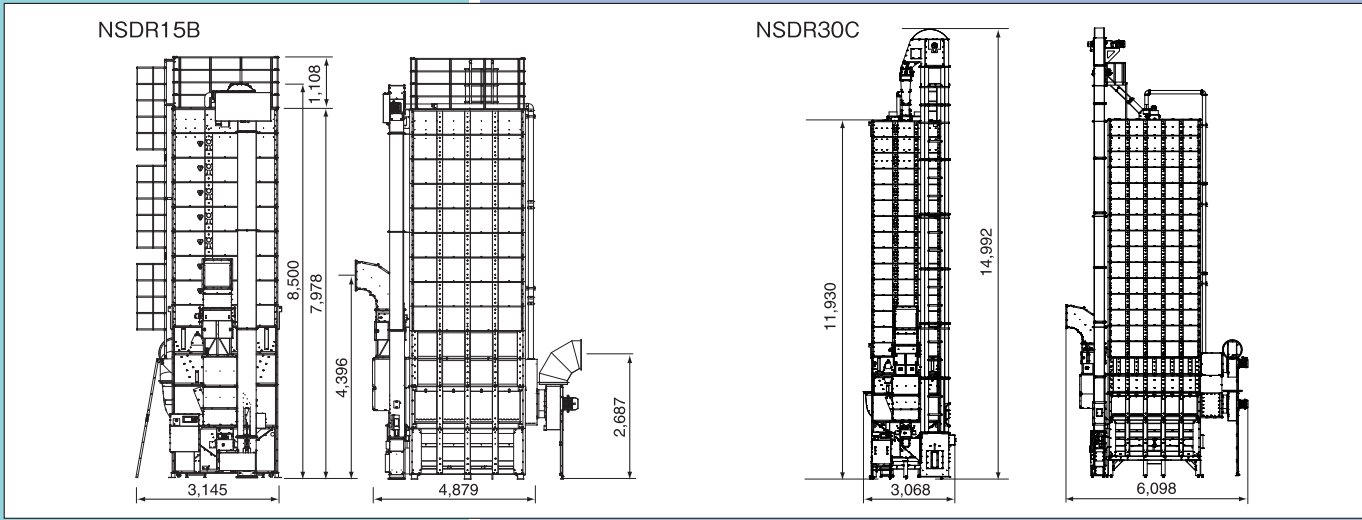

All copyright and trademark rights of this catalog belong to Satake Co., unless otherwise noted. Unauthorized copying, reprinting, etc. are forbidden. All Satake products are the subject of continuous development and, as a result, their specification may change and differ in detail from those shown.

SATAKE CORPORATION

Head Office 2-30 Saijo Nishihonmachi, Higashi-Hiroshima-shi, Hiroshima-ken, 739-8602, Japan URL : https://satake-group.com	SATAKE USA INC. 10900 Cash Road, Stafford, Texas, 77477, U.S.A. URL : www.satake-usa.com	SATAKE AMERICA LATINA LTDA. Rua Xavantes, 155-Pav. 20, Bairro Atiradores, CEP 89203-210, Joinville, Santa Catarina, Brazil URL : www.satake.com.br	SATAKE EUROPE LTD. Horsfield Way, Bredbury Industrial Park, Bredbury, Stockport, Cheshire, SK6 2SU, U.K. URL : www.satake-europe.com	SATAKE INDIA ENGINEERING PVT. LTD. 4th Floor, Tower-1, HB Twin Towers, A2, 3, 4, Netaji Subhash Place, Wazirpur District Centre, New Delhi, 110034, India URL : www.satakeindia.com
SATAKE (THAILAND) CO., LTD. 133,134 Moo 5, Bangkok, Mueang Pathum Thani, Pathum Thani 12000, Thailand URL : www.satake.th	SATAKE ASIA CO., LTD. No. 101, True Digital Park Griffin Building, 14th Floor, Unit No. 1407, Sukhumvit Rd, Bangkok, Phra Khanong, Bangkok, 10260, Thailand URL : www.satake.th	PT. SATAKE GOBEL INDONESIA Gedung Bumi Mandiri Tower I Lt.6 (601B), Jl. Basuki Rachmat 129-137 Surabaya, 60271 Indonesia URL : https://satake-group.com	SATAKE VIETNAM CO., LTD. Suite 101, No. 555 Tran Hung Dao Street, Cau Kho Ward, District 1, HCMC, Vietnam URL : https://satakevietnam.com	SATAKE MANUFACTURING (SUZHOU) CO., LTD. 229 Jin Feng Road, Suzhou New District, Suzhou City, Jiangsu Province, 215129, China URL : www.satake.cn

SATAKE AUSTRALIA PTY. LTD.
15 Leland Street, Penrith, N.S.W.,
2750, Australia
URL : www.satake.com.au

ISO 9001 Certification (Quality Management Systems)	SATAKE CORPORATION has obtained ISO9001 and ISO14001 certification. These international standards for management systems ensure Satake will continue to provide high quality products and services.
ISO 14001 Certification (Environmental Management Systems)	

Satake AI Dryer <AI...Artificial Intelligence>

Satake has developed the concept of "Optimum Drying" in its pursuit of total Engineering for the Grain Process.

Optimum Drying

1. Achieve higher yield (Less cracks & uniform quality)
2. Rapid Drying (Quick input, operation & discharge)
3. Effective Drying (Energy & heat source saving)

Satake gives you the best solution in drying.

Problem

- Unevenness of moisture content
- Unchangeable hot air temperature
- Loss of quality & yield

Internal cracked kernel



Solution

AI

- Satake's original calibration formula
- Automatic control of hot air, circulation speed & air volume



Advanced Color Touch Screen

Easy Operation

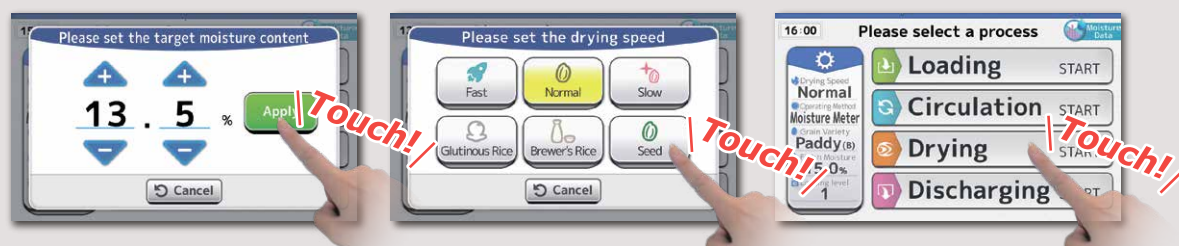

Drying Status



Mechanism of AI Dryer

Adoption of Multiple Sensors and Inverter allows for quality control and energy saving.

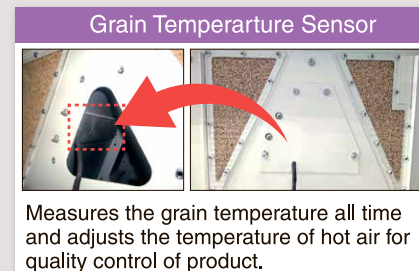

Measures the grain temperature all time and adjusts the temperature of hot air for quality control of product.



Inverter

Controls the blower automatically to dry grains with optimum air volume suitable to input capacity or moisture value.

* Product image for illustration purpose only. Actual product may vary.

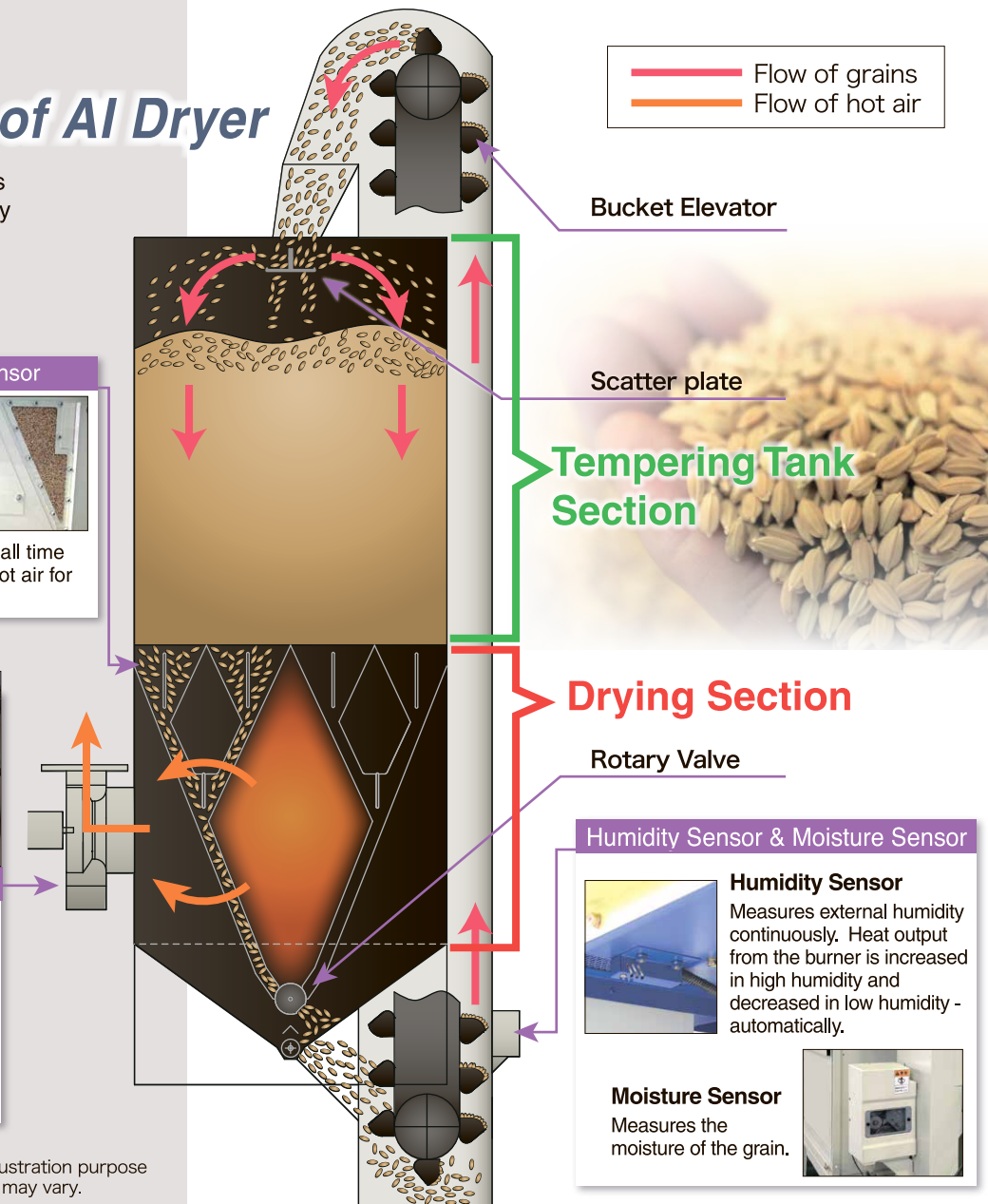

Option

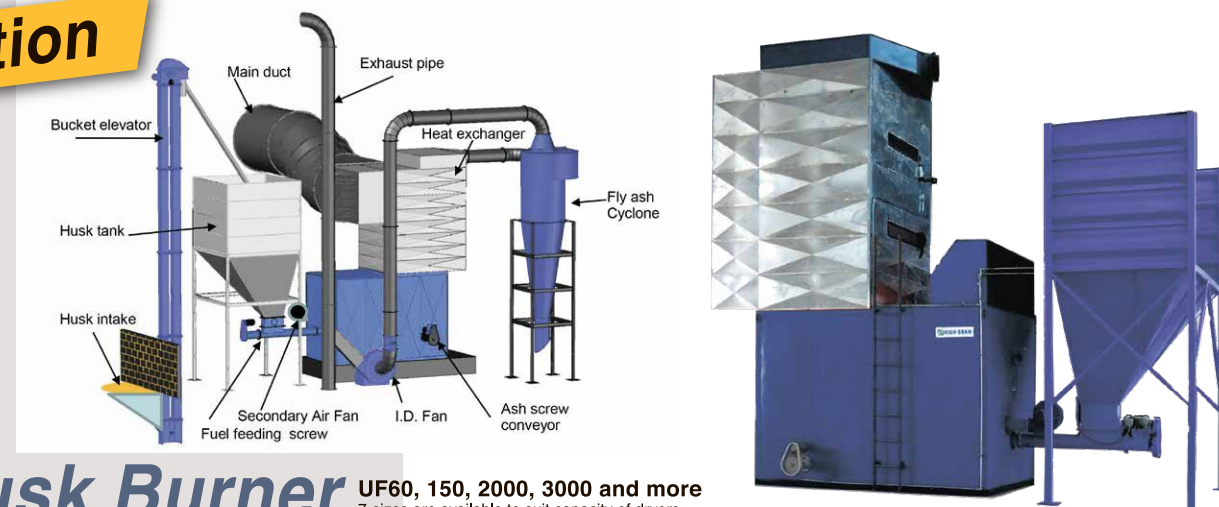

Husk Burner

UF60, 150, 2000, 3000 and more
7-sizes are available to suit capacity of dryers.

